

# Crystal Units

水晶振動子

Resistance Welded Type

抵抗溶接タイプ

HC-49/U

HC-49/T

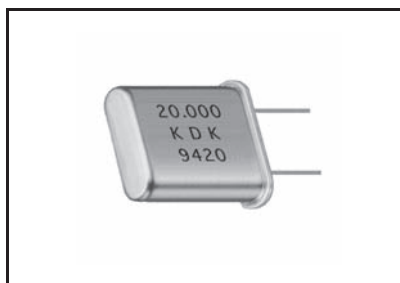

## Features 特徴

- Resistance Welded Package 電着封止パッケージ
- Wide Frequency Range 広帯域周波数範囲
- Excellent Solderability 優れたハンダ付性

## Specifications 仕様

|         | Freq. Range<br>周波数範囲 | Freq. Tolerance<br>周波数偏差 | Freq. Stability<br>周波数安定性 | Ope. Temp Range<br>動作温度範囲 | Drive Level<br>ドライブレベル |
|---------|----------------------|--------------------------|---------------------------|---------------------------|------------------------|
| HC-49/U | 1. 8MHz ~ 225MHz     | ± 30ppm 25°C             | ± 50ppm<br>(Ref. to 25°C) | -20°C ~ +70°C             | 1. 0mW (~ 3. 999MHz)   |
| HC-49/T | 6. 0MHz ~ 225MHz     |                          |                           |                           | 0. 1mW (4. 0MHz ~)     |

| Frequency Ranges<br>周波数範囲 | OSC. Mode<br>発振モード | CL<br>負荷容量 | ESR<br>等価直列抵抗<br>(max.) |
|---------------------------|--------------------|------------|-------------------------|
| 1. 800MHz ~ 1. 999MHz     | Fund               | 16pF       | 750 Ω                   |
| 2. 000MHz ~ 2. 399MHz     | Fund               | 16pF       | 500 Ω                   |
| 2. 400MHz ~ 2. 899MHz     | Fund               | 16pF       | 250 Ω                   |
| 2. 900MHz ~ 2. 999MHz     | Fund               | 16pF       | 200 Ω                   |
| 3. 000MHz ~ 3. 199MHz     | Fund               | 16pF       | 150 Ω                   |
| 3. 200MHz ~ 3. 499MHz     | Fund               | 16pF       | 120 Ω                   |
| 3. 500MHz ~ 4. 099MHz     | Fund               | 16pF       | 90 Ω                    |
| 4. 100MHz ~ 4. 399MHz     | Fund               | 16pF       | 80 Ω                    |
| 4. 400MHz ~ 4. 439MHz     | Fund               | 16pF       | 70 Ω                    |
| 4. 440MHz ~ 4. 799MHz     | Fund               | 16pF       | 60 Ω                    |
| 4. 800MHz ~ 4. 949MHz     | Fund               | 16pF       | 55 Ω                    |
| 4. 950MHz ~ 5. 499MHz     | Fund               | 16pF       | 50 Ω                    |
| 5. 500MHz ~ 5. 899MHz     | Fund               | 16pF       | 45 Ω                    |
| 5. 900MHz ~ 7. 099MHz     | Fund               | 16pF       | 40 Ω                    |
| 7. 100MHz ~ 8. 999MHz     | Fund               | 16pF       | 35 Ω                    |
| 9. 000MHz ~ 12. 499MHz    | Fund               | 16pF       | 30 Ω                    |
| 12. 500MHz ~ 15. 999MHz   | Fund               | 16pF       | 25 Ω                    |
| 16. 000MHz ~ 30. 000MHz   | Fund               | 16pF       | 20 Ω                    |
| 23. 000MHz ~ 70. 000MHz   | 3rd                | Series     | 40 Ω                    |
| 50. 000MHz ~ 130. 000MHz  | 5th                | Series     | 60 Ω                    |
| 100. 000MHz ~ 225. 000MHz | 7th                | Series     | 90 Ω                    |

## Case Dimensions ケース寸法

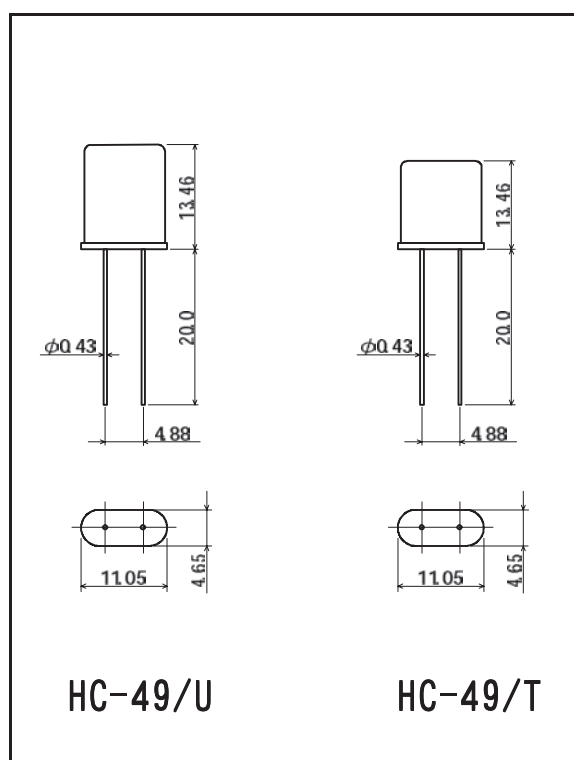

# Crystal Units

## 水晶振動子

### SX Series Microprocessor Crystals

### SXシリーズマイクロプロセッサ振動子

#### Specifications 仕様

| Holder<br>ホルダー                                      | HC-49/U              |  |
|---|----------------------|--|
| Freq. Tolerance at 25<br>周波数偏差                      | ± 50ppm              |  |
| Freq. Stability over -20 to +70<br>-20 ~ +70 周波数安定性 | ± 50ppm(Ref. to 25 ) |  |
| Parallel Capacitance(C0)<br>並列容量                    | 7pF max.             |  |
| Drive Level<br>ドライブレベル                              | 0.1mW                |  |
| Aging<br>エージング                                      | ± 5ppm/Year          |  |

| Series No.<br>シリーズナンバー | Frequency<br>周波数 | CL<br>負荷容量 | ESR<br>等価直列抵抗<br>(max.) |
|------------------------|------------------|------------|-------------------------|
| SX018                  | 1.8432MHz        | 13pF       | 800                     |
| SX020                  | 2.000MHz         | 32pF       | 500                     |
| SX021                  | 2.097152MHz      | 12pF       | 500                     |
| SX024                  | 2.4576MHz        | 32pF       | 300                     |
| SX030                  | 3.000MHz         | 16pF       | 150                     |
| SX032                  | 3.2768MHz        | 16pF       | 120                     |
| SX035                  | 3.579545MHz      | 16pF       | 100                     |
| SX036                  | 3.6864MHz        | 16pF       | 100                     |
| SX039                  | 3.93216MHz       | 16pF       | 100                     |
| SX040                  | 4.000MHz         | 16pF       | 100                     |
| SX04X                  | 4.096MHz         | 16pF       | 100                     |
| SX041                  | 4.194304MHz      | 12pF       | 80                      |
| SX043                  | 4.433619MHz      | 16pF       | 70                      |
| SX045                  | 4.500MHz         | 16pF       | 60                      |
| SX046                  | 4.608MHz         | 16pF       | 60                      |
| SX049                  | 4.9152MHz        | 16pF       | 55                      |
| SX050                  | 5.000MHz         | 16pF       | 50                      |
| SX05X                  | 5.0688MHz        | 16pF       | 50                      |
| SX051                  | 5.120MHz         | 16pF       | 50                      |
| SX05Y                  | 5.185MHz         | 16pF       | 50                      |
| SX057                  | 5.7143MHz        | 16pF       | 45                      |
| SX05Z                  | 5.760MHz         | 16pF       | 45                      |
| SX059                  | 5.9904MHz        | 16pF       | 40                      |
| SX060                  | 6.000MHz         | 16pF       | 40                      |
| SX061                  | 6.144MHz         | 16pF       | 40                      |
| SX064                  | 6.400MHz         | 16pF       | 40                      |
| SX065                  | 6.5536MHz        | 16pF       | 40                      |
| SX071                  | 7.15909MHz       | 16pF       | 40                      |
| SX072                  | 7.200MHz         | 16pF       | 40                      |
| SX073                  | 7.3728MHz        | 16pF       | 40                      |
| SX080                  | 8.000MHz         | 16pF       | 35                      |
| SX081                  | 8.192MHz         | 16pF       | 35                      |
| SX083                  | 8.388608MHz      | 16pF       | 35                      |

| Series No.<br>シリーズナンバー | Frequency<br>周波数 | CL<br>負荷容量 | ESR<br>等価直列抵抗<br>(max.) |
|------------------------|------------------|------------|-------------------------|
| SX092                  | 9.216MHz         | 16pF       | 30                      |
| SX098                  | 9.8304MHz        | 16pF       | 30                      |
| SX100                  | 10.000MHz        | 32pF       | 30                      |
| SX102                  | 10.240MHz        | 32pF       | 30                      |
| SX107                  | 10.73864MHz      | 32pF       | 30                      |
| SX110                  | 11.000MHz        | 32pF       | 30                      |
| SX11X                  | 11.0592MHz       | 32pF       | 30                      |
| SX120                  | 12.000MHz        | 32pF       | 30                      |
| SX122                  | 12.288MHz        | 32pF       | 30                      |
| SX135                  | 13.5168MHz       | 32pF       | 25                      |
| SX140                  | 14.000MHz        | 32pF       | 25                      |
| SX143                  | 14.31818MHz      | 32pF       | 25                      |
| SX147                  | 14.7456MHz       | 32pF       | 25                      |
| SX150                  | 15.000MHz        | 32pF       | 25                      |
| SX160                  | 16.000MHz        | 32pF       | 20                      |
| SX162                  | 16.257MHz        | 32pF       | 20                      |
| SX168                  | 16.384MHz        | 32pF       | 20                      |
| SX177                  | 17.734475MHz     | 32pF       | 20                      |
| SX180                  | 18.000MHz        | 32pF       | 20                      |
| SX184                  | 18.432MHz        | 32pF       | 20                      |
| SX196                  | 19.6608MHz       | 32pF       | 20                      |
| SX200                  | 20.000MHz        | 32pF       | 20                      |
| SX204                  | 20.480MHz        | 32pF       | 20                      |
| SX221                  | 22.1184MHz       | 32pF       | 20                      |
| SX240                  | 24.000MHz        | 32pF       | 20                      |
| SX250                  | 25.000MHz        | 32pF       | 20                      |
| SX270                  | 27.000MHz        | Series     | 40                      |
| SX300                  | 30.000MHz        | Series     | 40                      |
| SX320                  | 32.000MHz        | Series     | 40                      |
| SX360                  | 36.000MHz        | Series     | 40                      |
| SX480                  | 48.000MHz        | Series     | 40                      |
| SX1000                 | 100.000MHz       | Series     | 90                      |

(SX270 ~ SX1000 are overtone designs.)  
(SX270 ~ SX1000 はオーバートーン仕様です。)